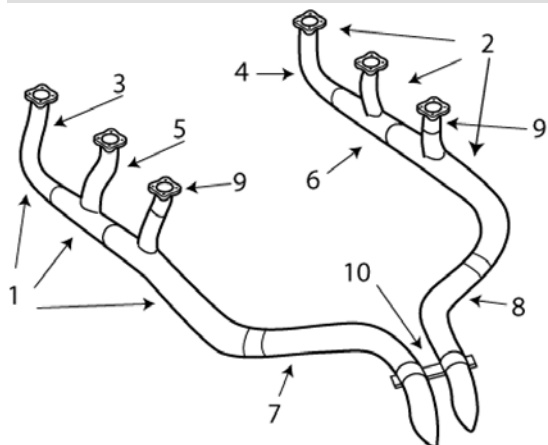

BEECHCRAFT**55 BARON**

Check diameter of exhaust system should be either 2.5" or 2" more commonly 2.5"

Inspect all slip joints for freedom of movement and leakage

Inspect tailpipes for pitting and wall thickness

| ITEM | OEM PART NO | DESCRIPTION | Condition |
|------|---------------|---------------------------------------|-----------|
| 01 | 96-950002LO-R | LE OTBD 4 PIECE STACK ASSEMBLY | OH |
| 01 | 96-950002RI-R | RE INBD 4 PIECE STACK ASSEMBLY | OH |
| 02 | 96-950002LI-R | LE INBD 4 PIECE STACK ASSEMBLY | OH |
| 02 | 96-950002RO-R | RE OTBD 4 PIECE STACK ASSEMBLY | OH |
| 03 | 96-950002-9 | LH FWD STACK | OH |
| 04 | 96-950002-33 | RH FWD STACK | OH |
| 05 | 96-950002-7 | LH CTR STACK | OH |
| 06 | 96-950002-31 | RH CTR STACK | OH |
| 07 | 96-950002-55 | LE OTBD TAILPIPE | OH |
| 07 | 96-950002-57 | RE INBD TAILPIPE | OH |
| 08 | 96-324101-1 | LE INBD TAILPIPE with MIXTURE CONTROL | OH |
| 08 | 96-324101-2 | RE OTBD TAILPIPE with MIXTURE CONTROL | OH |
| 08 | 96-950002-59 | LE INBD TAILPIPE | OH |
| 08 | 96-950002-61 | RE OTBD TAILPIPE | OH |
| 09 | 96-950002-47 | RISER, STUB | OH |
| 10 | 96-950011 | TAIL PIPE 1/2 CLAMP | NEW |
| NS | 628260 | GASKET | NEW |