

PIPER

22 TRI-PACER

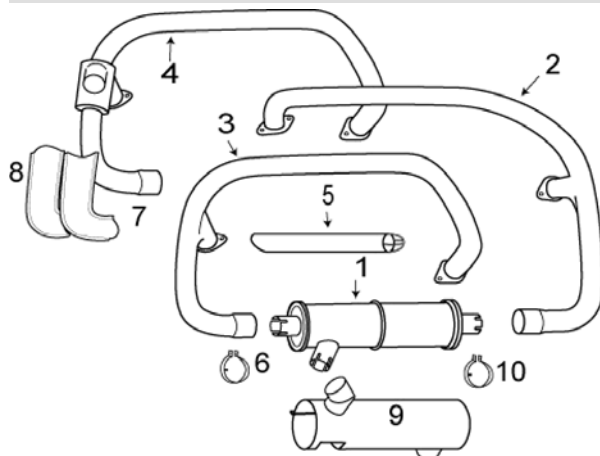

AD 68-05-01 for exhaust systems with less than 950 hr. time in service 100 hr. repetitive inspection of entire exhaust system and internal inspection of muffler. For systems with 950 hr. or more time in service the inspection requirement is every 50hrs.

Check under shroud for cracks and leaks
 Mufflers have internal baffles and they must be intact to be airworthy
 Check collector for cracking and heat distortion

ITEM	OEM PART NO	DESCRIPTION	Condition
01	10308-003	MUFFLER	OH
02	12043-23	FRONT STACK	OH
03	12043-22	REAR STACK	OH
04	13238-05	REAR STACK with Shroud	OH
05	11417-004	TAIL PIPE	OH
06	14235-00	TAILPIPE CLAMP 2"	NEW
07	10843-03	CARB HEAT SHROUD UPPER	OH
08	10764-03	CARB HEAT SHROUD LOWER	OH
09	12742-04	MUFFLER SHROUD	OH
10	CLAMP	MUFFLER CLAMP 2"	NEW
NS	10430-00	SHROUD CLIP	NEW
NS	77611	GASKET	NEW